



3PC FIRESAFE FB BALL VALVE - 12 BOLTED & FULLY ENCAPSULATED



JV-9300W

Feature	API-607 5th Edition Firesafe Approved Certificate Double D Stem, 12 Bolted, Fully Encapsulated
Port Bore	Full Bore
End	NPT, BSPT, ISO-228 Thread, Socket Weld, Butt Weld
Material	S/S; EN10213-4:1.4408; ASTM A351-CF8M C/S; EN10213-2:1.0619; ASTM A216-WCB
Pressure	1000PSI (PN63) for 2" to 3"
Testing	According to API-598 (EN12266-1,2)
Certificate	EN10204-3.1
Temp.	-20 °C to 200 °C (-4 °F to 392 °F)
Seat/Seal	PTFE (Virgin Pure PTFE) / GRAPHITE
Stem	AISI 316 Blow-out Proof with Anti-Static Device
Options	Padlocking Device Pneumatic or Electric Actuator



MATERIAL LIST

NO	PART	MATERIAL	
1	Body	CF8M = 1.4408	WCB = 1.0619
2	Cap	CF8M = 1.4408	WCB = 1.0619
3	Ball (Relief Hole)	CF8M = 1.4408	
4	Seat	PTFE	
5	Body Seal	GRAPHITE	
6	Anti-Static Stem	AISI 316 = 1.4401	
7	Thrust Washer	GRAPHITE	
8	Stem Packing	GRAPHITE	
9	Gland Ring	AISI 304 = 1.4301	
10	Belleville Disc	AISI 301 = 1.4310	
11	Nut Stopper	AISI 304 = 1.4301	
12	Stem Nuts	A2 = A194-8 = SUS 304	
13	Locking Device	AISI 304 = 1.4301	
14	Handle	AISI 304 = 1.4301	
15	Handle Sleeve	PVC	
16	Hex Cap Screws	A2 = A193-B8 = SUS 304	
17	Stop Pin	AISI 304 = 1.4301	
18	Hex Cap Screws	A2 = A193-B8 = SUS 304	

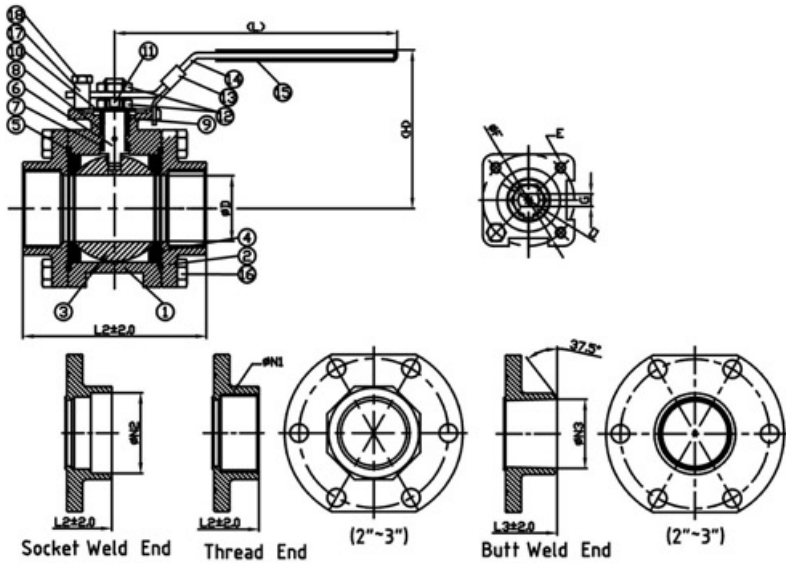

DIMENSIONS (mm)

SIZE	ΦD	L	L2	L3	H	F	E	G	O	ΦN1	ΦN2	ΦN3	WT (KG)		
													Thread	BW	SW
2"	50.8	218	140	150	121	F07	M8	9.5	5/8"-18UNF	ISO-228	61.4	52.7	7.74	7.67	7.74
2-1/2"	65	376	185	190	165	F10	M10	17	7/8"-14UNF	PT	77.1	65.6	13.24	13.12	13.33
3"	76	376	205	220	181	F10	M10	17	7/8"-14UNF	NPT	90	80.5	21.67	21.29	21.71

JV-9300W 09