

1 PC Lever Operated Ball Valve

VB1B – 1 Piece Ball Valve

REDUCED BORE

BLOW OUT PROOF STEM

LOCKING DEVICE

1000 PSI (69 BAR) W.O.G.

TESTING TO API 598

BSP/NPT THREADED

TEMP RANGE -20 – 200 DEG C



ENERGY VALVES

NO	PART NAME	MATERIALS
1	BODY	CF8M
2	INSERT	CF8M
3	BALL	CF8M
4	BALL SEAT	PTFE
5	STEM	S/S 316
6	THRUST WASHER	PTFE
7	STEM SEAL	PTFE
8	GLAND WASHER	S/S 304
9	SPRING WASHER	S/S 304
10	NUT	S/S 304
11	LEVER HANDLE	S/S 304
12	HANDLE SLEEVE	PLASTIC

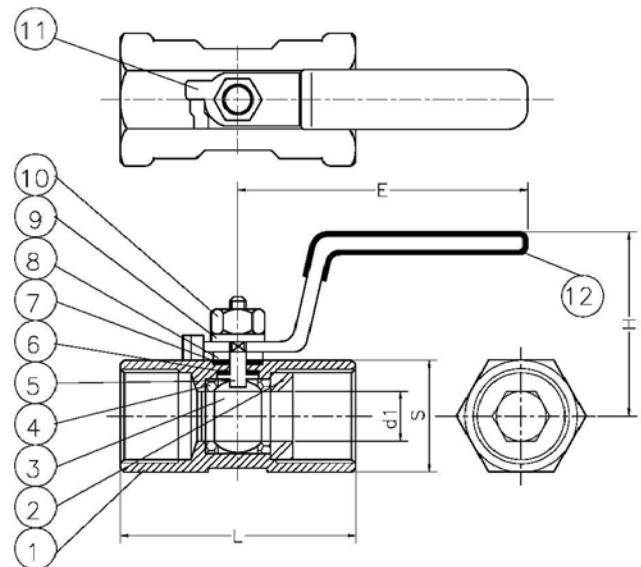

DIMENSIONS:

SIZE	d	L	H	W	Cv FACTOR	KGs
¼"	5	40	33	67	4	0.06
3/8"	7	45	36	67	4	0.1
½"	9	58	37	93	4.5	0.16
¾"	12.5	60	42	93	9	0.26
1"	16	71	52	103	16	0.38
1 ¼"	20	78	56	103	24	0.61
1 ½"	25	82.5	65	125	37	0.85
2"	32	100	70	125	68	1.4

Energy Valves is a division of Energy Engineered Products (Pty) Ltd.

30 Monte Carlo Crescent Kyalami Park, Midrand, South Africa

Tel: +27 11 466 1926 Fax: +27 11 466 1692 Email: sales@energyproducts.co.za Web: www.energyproducts.co.za