

3-Way Lever Operated Ball Valve with ISO 5211 Mounting Pad

VBLB/VBTB

REDUCED BORE
 BLOW OUT PROOF STEM
 LOCKING DEVICE
 1000 PSI (69 BAR) W.O.G.
 TESTING TO API 598
 BSP/NPT THREADED
 TEMP RANGE -20 – 200 DEG C
 L-PORT & T-PORT CONFIGURATION



ENERGY VALVES

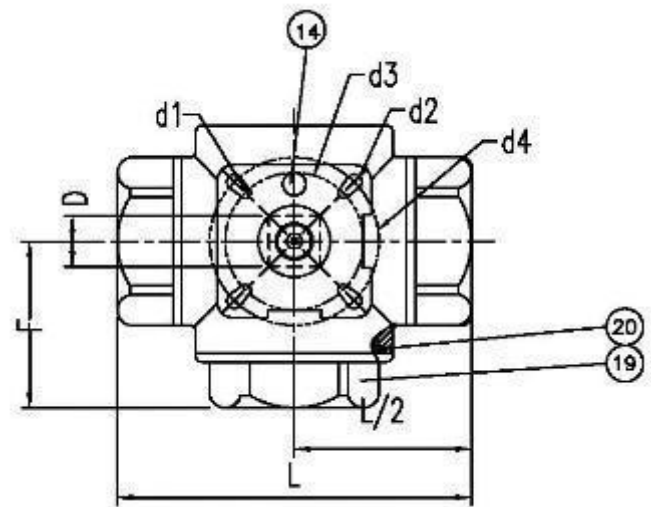
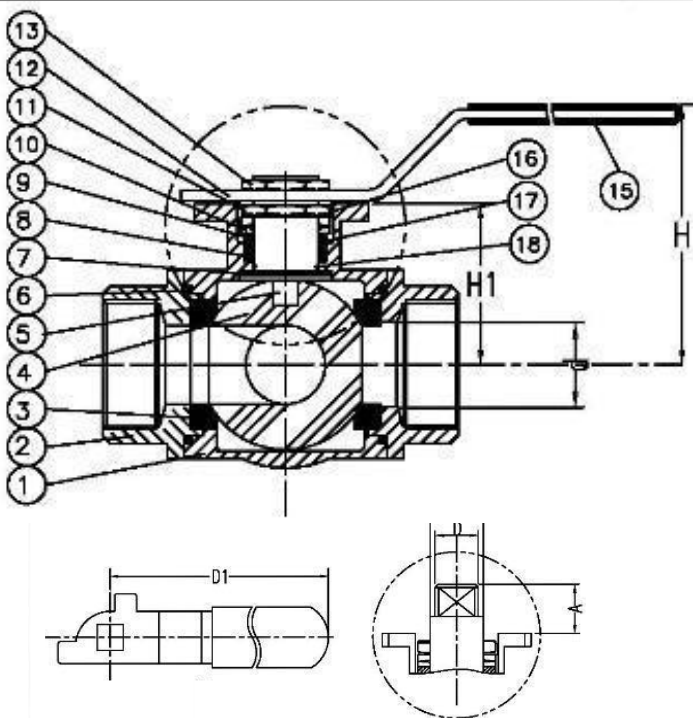

DIMENSIONS (MM)

* (Torque figures are express at atmospheric pressure and temperature and do not include a safety factor)

SIZE	d	L	H	D1	A	C	D	F	d1	d2	d3	d4	H1	TORQUE (Nm)*
1/4"	11.0	75.7	77.4	112	9	12	9	37.2	-	6	-	42	38.2	6
3/8"	11.0	75.7	77.4	112	9	12	9	37.2	-	6	-	42	38.2	6
1/2"	12.7	75.7	77.4	112	9	12	9	37.2	-	6	-	42	38.2	12
3/4"	16.0	86.6	82	112	9	12	9	44.7	-	6	-	42	45.2	16
1"	20.0	102.4	93.7	136.5	11	15.8	11	51.4	-	7.1	-	50	56.5	20
1 1/4"	25.0	118.2	101.1	188	11	15.8	11	57.7	-	7.1	-	50	61.9	22
1 1/2"	32.0	125.8	120.2	197.5	14.3	20.8	14	62.7	7.1	9.2	50	70	78.2	30
2"	38.1	149	129.8	197.5	14	20.8	14	74.6	7.1	9.2	50	70	87.3	45

NO	PART NAME	MATERIALS
1	BODY	CF8M
2	CAP	CF8M
3	SEAT	25% R-PTFE
4	BALL	CF8M
5	STEM	S/S 316
6	GASKET	25% R-PTFE
7	THRUST WASHER	R-PTFE
8	PACKING	PTFE
9	GLAND BUSH	S/S 304
10	BELLEVILLE WASHER	S/S 304

NO	PART NAME	MATERIALS
11	HANDLE NUT	S/S 304
12	HANDLE	S/S 304
13	HANDLE NUT	S/S 304
14	STOP PIN	S/S304
15	HANDLE SLEEVE	PLASTIC
16	STOP WASHER	S/S 304
17	THRUST WASHER	15% R-PTFE
18	O-RING	VITON
19	END CAP	CF8M
20	GASKET	25% R-PTFE

Energy Valves is a division of Energy Engineered Products (Pty) Ltd.
 30 Monte Carlo Crescent Kyalami Park, Midrand, South Africa

Tel: +27 11 466 1926 Fax: +27 11 466 1692 Email: sales@energyproducts.co.za Web: www.energyproducts.co.za